

MB&F

HOROLOGICAL LAB

LEGACY MACHINE SEQUENTIAL EVO

Congratulations for your purchase!

You are the proud owner of a high complication timepiece by MB&F.

Chronograph mechanisms are highly complex, so please read these instructions carefully before operating your timepiece.

LM SEQUENTIAL EVO

FUNCTIONS

07

OPERATING INSTRUCTIONS - WINDING

09

OPERATING INSTRUCTIONS - TIME SETTING

11

OPERATING INSTRUCTIONS - INDEPENDENT TIMING MODE

13

OPERATING INSTRUCTIONS - SIMULTANEOUS TIMING MODE

15

OPERATING INSTRUCTIONS - SEQUENTIAL TIMING MODE

17

IMPORTANT OPERATING INFORMATION

19

LM SEQUENTIAL EVO



FUNCTIONS

- 1 Hours and minutes
- 2 Left chronograph: seconds
- 3 Left chronograph: minutes
- 4 Right chronograph: minutes
- 5 Right chronograph: seconds
- 6 Power reserve indicator

LM SEQUENTIAL EVO

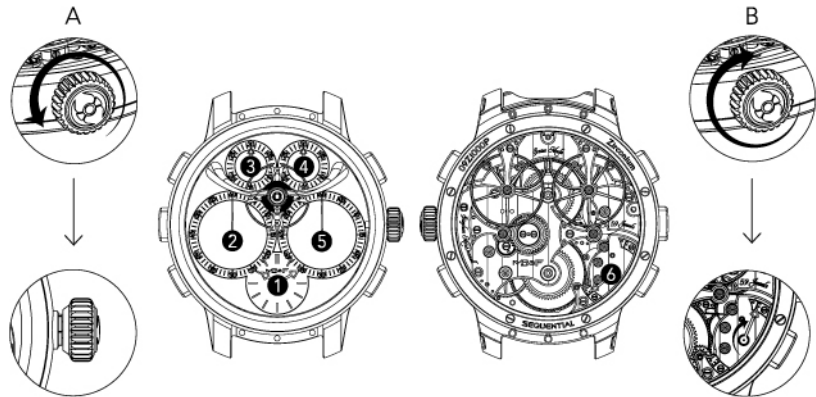

OPERATING INSTRUCTIONS - WINDING

Your watch is equipped with a manual winding movement.

To wind the watch, you must first unscrew the crown (counterclockwise) to release it (A). Then wind the crown until you reach the maximum power reserve capacity (B) as shown in the power reserve indicator (6).

LM SEQUENTIAL EVO

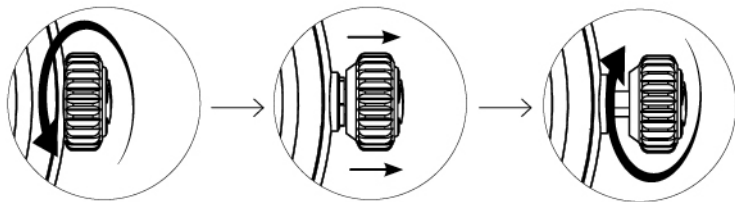

OPERATING INSTRUCTIONS - TIME SETTING

First, unscrew the crown (counterclockwise) to release it, then pull the crown to the "Out" position, and turn the crown to set the time. Push the crown back against the case and don't forget to screw it in again (clockwise) – this will guarantee water resistance.

LM SEQUENTIAL EVO

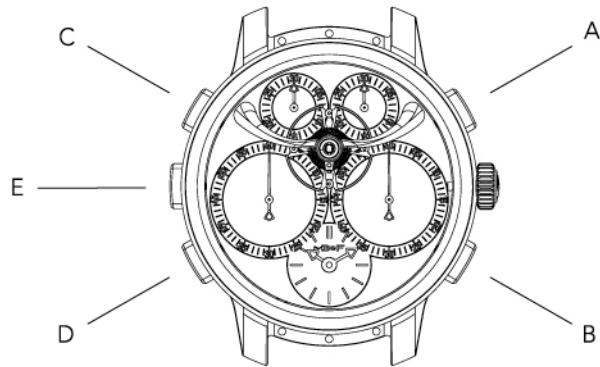

OPERATING INSTRUCTIONS - INDEPENDENT TIMING MODE

The dial plate features two chronograph displays and each of these chronograph displays can be started, stopped and reset completely independently of each other, using the start/stop and reset pushers on their respective sides of the case.

For example, use the start/stop pusher (A) to start the right chronograph. The hands of the seconds and minute counters are now running. Pressing (A) once more will stop the chronograph. You can restart and stop the chronograph as many times as you wish. Use the pusher (B) to reset the right chronograph.

LM SEQUENTIAL EVO

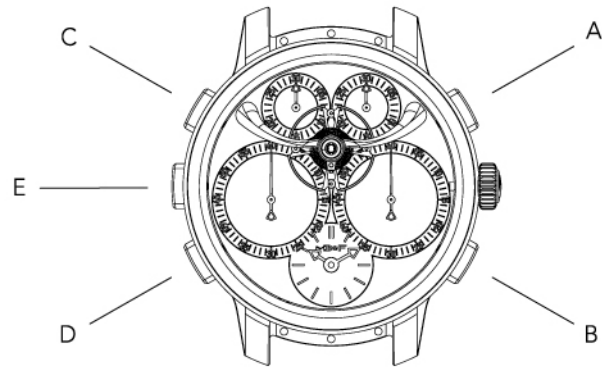

OPERATING INSTRUCTIONS - SIMULTANEOUS TIMING MODE

The dial plate features two chronograph displays. The "Twinverter" (E) controls both chronograph systems, operating as a binary switch that inverts the current start/stop status on each chronograph. This means that if both chronographs are stopped, pressing the Twinverter will cause both of them to start simultaneously.

For example, use the "Twinverter" pusher (E) to start both chronographs simultaneously. The minute and seconds hands of both chronograph displays are now running. Pressing (A) will stop the chrono hands for the right chronograph. Use the pusher (C) to stop the left chronograph. Use the pushers (B/D) to reset both chronographs.

LM SEQUENTIAL EVO

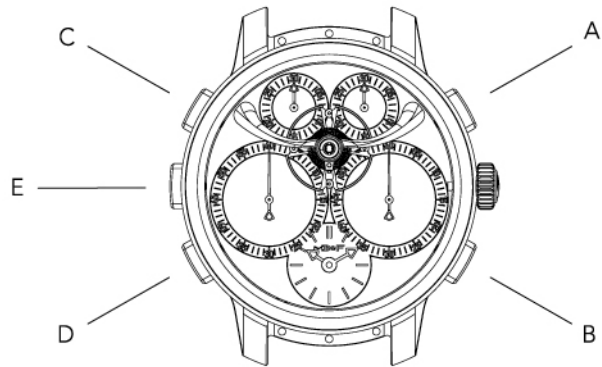

OPERATING INSTRUCTIONS - SEQUENTIAL TIMING MODE

The dial plate features two chronograph displays. The "Twinverter" (E) controls both chronograph systems, operating as a binary switch that inverts the current start/stop status on each chronograph. This means that if one is running and the other is stopped, the Twinverter stops the one that is running and starts the one that is stopped.

For example, use the start/stop pusher (A) to start the right chronograph. Press the "Twinverter" pusher (E); the right chronograph will stop and the left chronograph will start. Use the pusher (B) to reset the right chronograph. Press the "Twinverter" pusher (E); the left chronograph will stop and the right chronograph will start. Use the pusher (D) to reset the left chronograph. And so on... The sequential timing mode thus allows multiple flying lap times to be measured one after the other.

LM SEQUENTIAL EVO

IMPORTANT OPERATING INFORMATION

Finally, please note the following important points on operating the LM Sequential EVO:

- Chronographs are fragile and can be damaged easily.
- If the chronographs are running, please do not force the reset mode; only use the pushers (B/D) when the chronographs are stopped.
- Be careful never to apply excessive force to the pushers; only use your fingers and no other tools which could not only force the movement, but also slip and scratch the case.
- If the crown does not wind the watch, never apply excessive force; this simply indicates that the movement is fully wound.

